

SLU-0200 Phase Monitor Relays (3-Phase Monitors) provide cost-effective protection against premature equipment failure caused by voltage faults on 3-Phase systems (Wye or Delta). The SLU-0200 Series multi-mode phase monitoring relay, was designed for the convenience of electrician's, maintenance managers and engineers. This device can be easily adjusted for the voltage, imbalance percentage and time delay requirements to protect against unbalanced voltages or single phasing regardless of any regenerative voltages.

Both **DELTA** and **WYE** systems may be monitored. In Wye systems, connections to neutral are NOT required. The SLU-0200 Series is UL Listed under UL File Number E55826.

**NOTE:** Can be used for most generator applications. Not recommended for variable frequency drive applications. Call technical support for application assistance.



**Universal Phase Monitor  
w/ Rapid Cycle Lockout**

<b>AUTO RANGING SCALES</b>	Frequency	Nominal Line-to-Line Voltages	Adjustable Range
	60Hz	208, 220, 240, 380, 415, 440, 460, 480	200-250 360-500
	50Hz	208, 220, 240 346, 380, 415	200-250 330-430
<b>VOLTAGE BAND</b>	Drop-out	±10% of Range Setting (Under/Over)	
	Pick-up	±7% of Range Setting (Under/Over)	
<b>MAXIMUM VOLTAGE</b>	550 VAC (Line-to-Line)		
<b>PHASE SEQUENCE</b>	ABC (Will Not Operate On CBA Sequence)		
<b>POWER REQUIRED</b>	90VA Max.		
<b>PHASE UNBALANCE</b>	2% to 10%, Adjustable Drop-out		
	Hysteresis	10% of Setting	
<b>PHASE SHIFT</b>	13° Drop-out, 12° Pick-up (Ø-Loss)		
<b>FREQUENCY SHIFT</b>	Not Detected		
<b>RAPID CYCLE</b>	5 Cycle Lockout, 30 minute cycle count reset		
<b>RESET</b>	Automatic		
<b>RELAY OUTPUT</b>	SPDT, 10A @ 240VAC Resistive, 1/2 HP @240VAC		
<b>INDICATORS</b>		Flashing	Continuous
	Normal (Green LED)	Fault Delay Active	Relay Energized
	Fault (Red LED)	Restart Delay Active	Relay De-energized
<b>RESPONSE</b>	Power Up	2.5 SEC Minimum	
	Fault Delay	1 to 25 SEC., Adjustable	
	Severe Fault	1 SEC. (Phase-Loss, Unbalance or Phase Reversal)	
	Restart	0.5 to 300 S, Adjustable (Auto Reset)	
<b>TEMPERATURE RATINGS</b>	Operate	32° to 131°F (0° to +55°C)	
	Storage	-49° to 185°F (-45° to +85°C)	
<b>REPEAT ACCURACY</b>	1% @ Fixed Condition		
<b>ENCLOSURE</b>	Style "A"	8-Pin Plug In LEXAN® Dust Cover	
<b>WEIGHT</b>	0.35 to 0.5 lbs.		

**TOP LABEL**

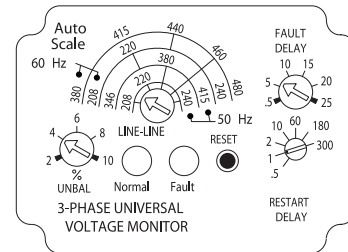

**DIMENSIONS (INCHES)**

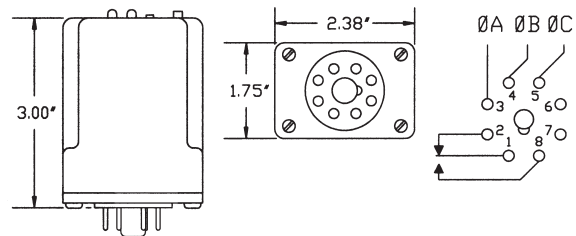

**ORDERING INFORMATION**

MODEL NUMBER	DESCRIPTION
SLU0200	Voltage/Phase Monitor