

Type 3215

Weatherproof Regulator with Super High Flow

Description

The T3215 High-Flow Pressure Controller utilizes reliable, quick-firing solenoids, an onboard pressure sensor, and a precision 180 scfm booster to achieve excellent accuracy and stability. There are many custom output ranges between 0 and 150 PSIG (1.0 MPa). The T3215 is CE-rated, weatherproof, and vibration-resistant. Analog electrical connections include control and monitor output. Mounting options include in-line and panel.

The T3215 is available with or without pressure monitor and logic outputs (6-pin or 4-pin micro connector, respectively). The T3215 is also available with a 6-pin DIN 43650 connector. Differential inputs mean problem-free integration with PLC grounding systems.

Features

- Single Unit-Integrated Controller and Booster
- Very High Flow Volume Booster-Greater than 200 SCFM
- High Accuracy Control of Air Pressure
- Low Air Consumption
- Weatherproof Housing
- Shock Resistant, Position Insensitive
- CE Approved

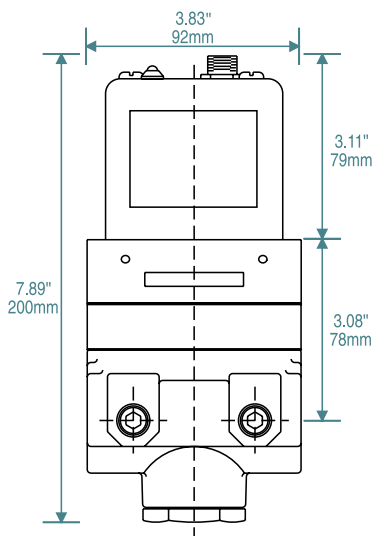

Type 3215
Weatherproof Regulators

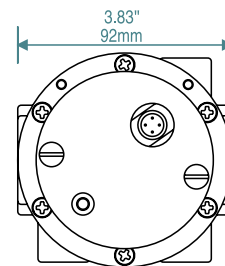

Mounting Bracket
Part Number 161-800-00

Type 3215 Ordering Information

| 215 | | O | G | P | | OO | |
|-----|---|---|---|---|-----|----|--------------------------------|
| | ▲ | | | | | | Logic Output |
| | M | | | | | | CMOS |
| | T | | | | | | TTL |
| | O | | | | | | Open-Collector |
| | Z | | | | | | No Logic Output |
| | | | | | | | Analog Control Signal |
| | E | | | | | | 0-10V |
| | I | | | | | | 4-20mA |
| | | | | | | | Lower Output Pressure |
| | | O | | | | | Lower Limit of Output Pressure |
| | | | | | | | Pressure Units |
| | | | G | | | | PSIG |
| | | | | | | | Upper Output Pressure |
| | | | | | 030 | | 30 PSIG |
| | | | | | 100 | | 100 PSIG |
| | | | | | 150 | | 150 PSIG |
| | | | | | | | Mounting |
| | | | | | | P | Pipe (in-line) |
| | | | | | | | Supply and Output Ports |
| | | | | | | 3 | 3/8 NPT |
| | | | | | | 4 | 1/2 NPT |
| | | | | | | 6 | 3/4 NPT |
| | | | | | | 8 | 1 NPT |
| | | | | | | | Connector |
| | | | | | | 1 | Micro Connector |
| | | | | | | D | DIN 43650 Connector |
| | | | | | | | Options |
| | | | | | | OO | None |

Type 3215

| | | |
|--|---|------------------------|
| Performance | Full-Scale Accuracy 1.0% | |
| Electrical Inputs | | |
| Supply Voltage | 15-24VDC (12VDC option) | |
| Stand by Supply Current | 80 mA | |
| Maximum Supply Current | 325 mA | |
| E/P Control | 0-10V, 10K OHMS | |
| I/P Control | 4-20 mA , 250 OHMS | |
| Electrical Outputs | | |
| Monitor Output | 0-10V | |
| Logic Output | CMOS, TTL, Open-Collector | |
| Pneumatic Inputs | | |
| | Max. Output PSIG (BAR) | Max. Supply PSIG (BAR) |
| | Up to 5 (.35) | 20 (1.4) |
| Supply Pressure | >5 to 15 (.35-1.03) | 30 (2.1) |
| | >15 to 30 (1.03-2.1) | 60 (4.1) |
| | >30 to 100 (2.1-6.9) | 165 (11.4) |
| | >100 to 150 (6.9-10.3) | 200 (13.8) |
| Pneumatic Outputs | | |
| Full-scale Atmospheric Pressure Ranges | 30, 100, 150, PSIG | |
| Forward Flow Capacity | 180 SCFM (5100 LPM) | |
| Exhaust Flow Capacity | 30 SCFM (850 LPM) | |
| Environmental | | |
| Operating Temperature | 32-141 °F (0-60 °C) | |
| Media-Wetted Materials | Aluminum, copper alloys, nickel, buna-n, silicon, 316SS | |
| Required Accessories | 4 or 6-pin micro cordset | |
| Recommended Accessories | Panel Bracket, Power Supply, Control Knob | |