

OPERATION

Lo-Limit: If the monitored input voltage drops below the "lo-limit drop-out" voltage, the under-voltage sensor de-energizes the output relay. When the under voltage rises to the "lo-limit pick-up" voltage, the under-voltage sensor energizes the output relay.

Hi-Limit: If the monitored input voltage rises to the "hi-limit drop-out" voltage, the over-voltage sensor de-energizes the output relay. When the over-voltage drop to the "hi-limit pick-up" voltage, the over voltage sensor energizes the output relay.

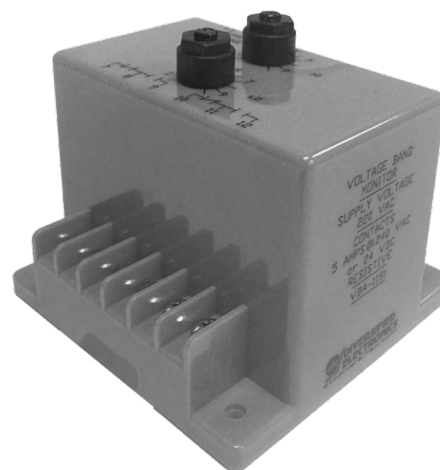

Voltage Band Monitor

DIMENSIONS (INCHES)

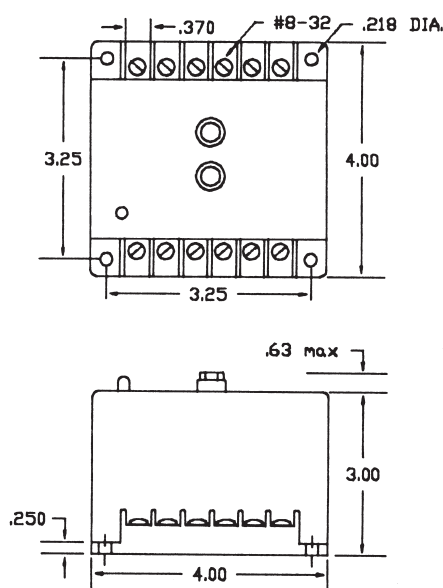

SPECIFICATIONS

NOMINAL VOLTAGE	220 VAC	
LOW LIMITS	Pick-up	180 to 220 VAC, Adj. Factory Set @ 203 VAC
	Drop-out	165 to 205 VAC, (Tracks 15 VAC Below Pick-up)
HIGH LIMITS	Drop-out	230 to 260 VAC, Adj. Factory Set @ 258 VAC
	Pick-up	226 to 256 VAC, (Tracks 4 VAC Below Drop-out)
RESPONSE TIMES	Pick-up	100 mSeconds (Approximately)
	Drop-out	0.5 Seconds (Approximately)
TEMPERATURE	Operate	-18° to 149°F (-28° to 65°C)
	Storage	-49° to 185°F (-45° to 85°C)
OUTPUT	DPDT Relay, 5 Amps @ 240 VAC or 24 VDC, Resistive	
POWER REQUIRED	3 Watts (Approximately)	
ENCLOSURE	Style "E"	

ORDERING INFORMATION

MODEL NUMBER	DESCRIPTION
VBA-1191	Voltage Band Monitor